

PLUG-IN ASSEMBLY INSTRUCTIONS FOR Ashton Wall Lamp

3434-01 1.0

Model # 3434-01

1.

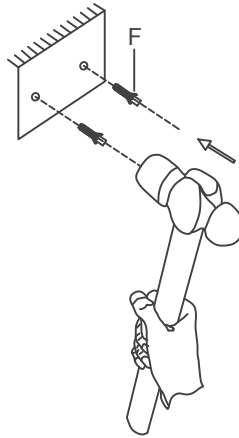
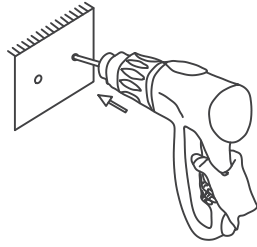
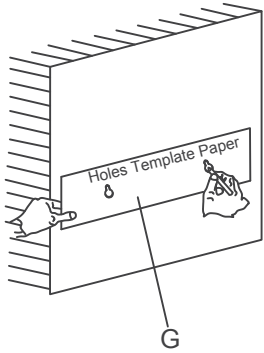

1. Remove all items from packaging. Drill 2 light holes in the wall and then nail the plastic bolts (F) into wall.
Note : Take out the paper template (G) from part bag and then place onto the wall. Use the paper (G) to get the spacing for the holes correct on the item before marking the walls and drilling.
2. Align holes with plastic bolts (F) and attach with 2 screws (E).Secure screws (E) with a phillips head screwdriver.
3. Hang the part(H) onto the wall and adjust the lamp base in the correct direction.
4. Set shade (C) on lamp socket (D) and tighten clockwise with socket ring (B) to secure shade.
5. Screw bulb(A) clockwise into socket to tighten.

2.

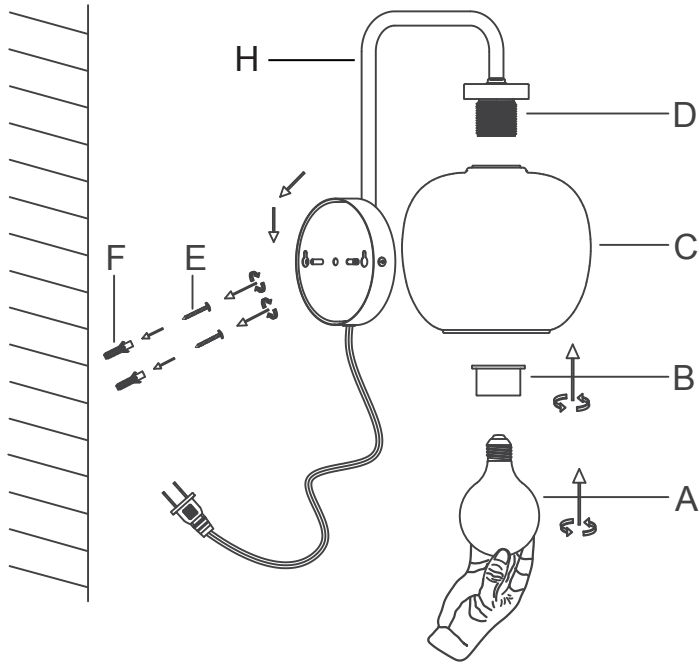

GENERAL PRODUCT INFORMATION:

This product is suitable for dry locations only.



IMPORTANT SAFETY INSTRUCTIONS:

This portable lamp has a polarized plug (one blade is wider than the other) as a feature to reduce the risk of electric shock. This plug will fit in a polarized outlet only one way. If the plug does not fit fully in the outlet, reverse the plug. If it still does not fit, contact a qualified electrician. Never use with an extension cord unless plug can be fully inserted. **DO NOT ALTER THE PLUG.**

BULB TYPE: (1) 40 watt type A vintage bulb included.

PART

